

TYPE: WKN 2c...*

- (*) - WKN cgw - connections welded / threaded
- WKN ccu - connections welded / copper
- WKN 2g - threaded connections

Temperature range from -20°C to $+200^{\circ}\text{C}$

Pressure: PN 16 - 40

Notes:

- Internal pipe thread according to PN-ISO 228-1
- flange measurements according to PN-EN 1092-1 others according to agreements
- sealing faces of the flanges acc. to PN/H-74307 others according to the agreements

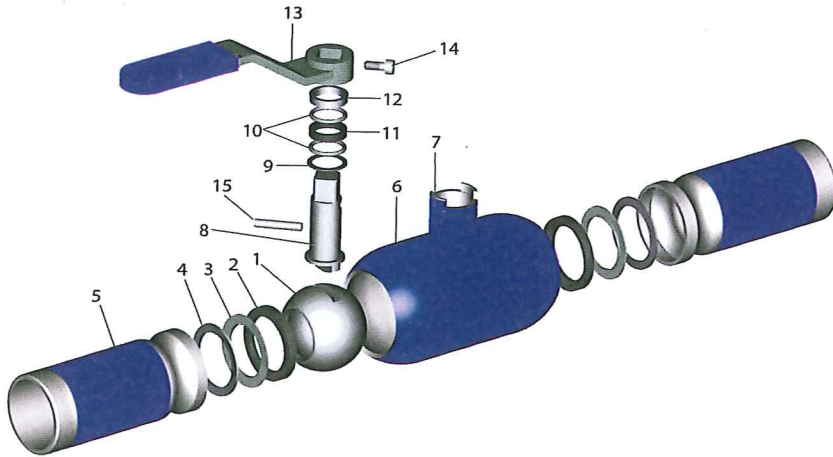

WKN cgw - connections welded / threaded



WKN ccu - connections welded / copper



WKN 2g - threaded connections



Applications:

heat distribution and air conditioning systems, water supply and industrial systems (media of group 2 – water, air, oils and other media which do not react with carbon steel).

Caution: the drawing and the material information are for the valve WKN 2c DN40

Limited flow welded ball valve

Material specification		
No	Name of the part	Material
1	Ball	X5CrNi18-10
2	Seal	PTFE+20%C
3	Seal seat	X5CrNi18-10
4	Spring	50CrV4
5	Connector pipe	P355N
6	Body	P355N
7	Chimney	P355N
8	Mandrel	X8CrNiS18-9
9	Lower ring	PTFE+20%C
10	O-ring	FMQ, FKM
11	Seal	PTFE+20%C
12	Gland	X20Cr13
13	Grip	St3S
14	Screw	PN-EN ISO 14580:2004
15	Straight pin	PN-EN ISO 2338:2003

Caution: other materials according to agreements.

Valves' temperature working range at maximum pressure

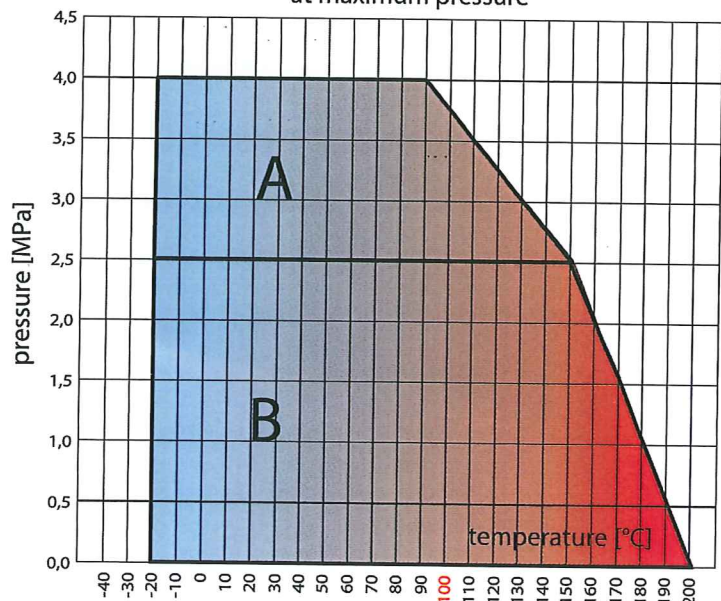

Scope of operation: A+B- DN10;15;20;25;32;40;50 B - DN65;80;100;125;150;200;250

TYPE: WKN 2c...*

- (*) - WKN cgw
- WKN ccu
- WKN 2g

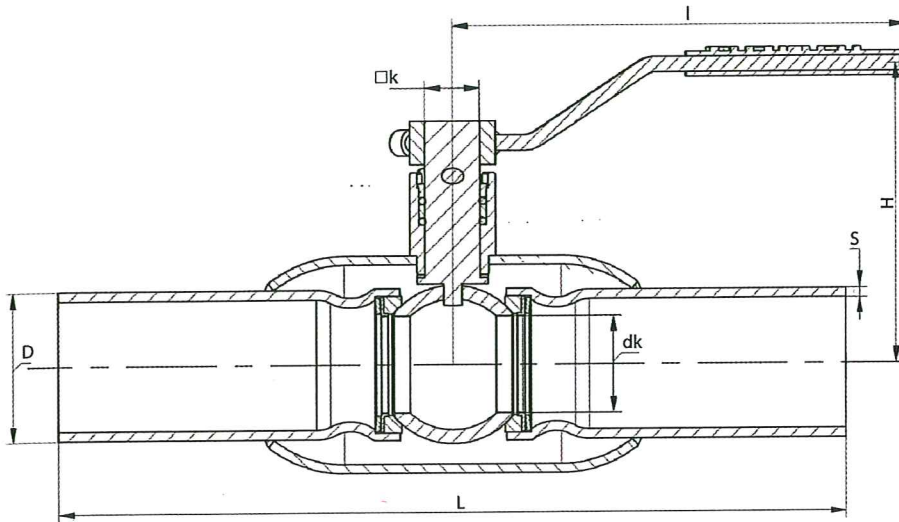

WKN cgw - connections welded / threaded

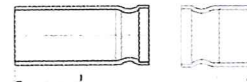

WKN ccu - connections welded / copper

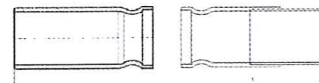

WKN 2g - threaded connections

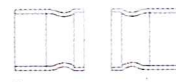

Limited flow welded ball valve

Dimension chart												
PS	DN	dk	D	s	L-2c	L-cgw	L-ccu	L-2g	l	H	k	Kvs
bar	mm	mm	mm	mm	mm	mm	mm	mm	mm	mm	mm	m ³ /h
16-40	10	10	17,2	2,0	230	152,5	255	65	140	62	Slotted hole d ₁ =65; d ₂ =10	7,0
16-40	15	10	21,3	2,3	230	152,5	255	65	140	65	Slotted hole d ₁ =65; d ₂ =10	7,0
16-40	20	15	26,9	2,6	230	152,5	260	75	140	80	Slotted hole d ₁ =65; d ₂ =10	9,8
16-40	25	20	33,7	3,2	230	160	265	90	140	83	Slotted hole d ₁ =65; d ₂ =10	16,2
16-40	32	25	42,4	3,2	260	182,5	-	105	160	94	14	26,9
16-40	40	32	48,3	3,2	260	190	-	120	160	97	14	47,5
16-40	50	40	60,3	3,6	300	222,5	-	145	200	124	17	99,8
16-25	65	50	76,1	3,6	300	-	-	-	200	123	17	166,7
16-25	80	65	88,9	3,6	300	-	-	-	280	160	19	282
16-25	100	80	114,3	3,6	325	-	-	-	280	167	19	425
16-25	125	100	139,7	4,5	350	-	-	-	280	186	19	730
16-25	150	125	168,3	5,0	350	-	-	-	400	199	25	1085
16-25	200	150	219,1	9,0	400	-	-	-	600	211	25	1900
16-25	250	200	273	8,8	520	-	-	-	900	254	27	2890