

---

*Installation and Operation Instructions for*

# **KLINGER**

## **AB Straight-Way Cocks**

*Asbestos-free type*

---

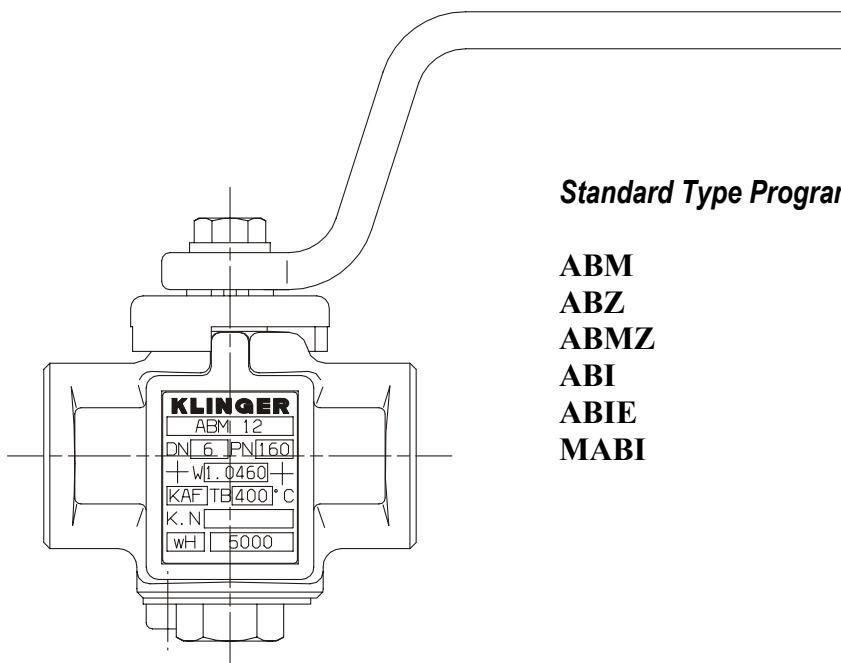

**Standard Type Programm**

**ABM  
ABZ  
ABMZ  
ABI  
ABIE  
MABI**

**Edition: 11/2004**



**Fluid Control GmbH**  
Am Kanal 8-10  
A-2352 Gumpoldskirchen/AUSTRIA

Telefon: ++43(0) 2252 / 600 - 0  
Telefax: ++43(0) 2252 / 63336  
          ++43(0) 2252 / 600 - 242  
e-mail: [office@klinger.kfc.at](mailto:office@klinger.kfc.at)  
WEB: [www.klinger.kfc.at](http://www.klinger.kfc.at)

---

## ***Table of Contents***

<b><i>Page 3</i></b>	<b><i>Operating principle</i></b>
<b><i>Page 4</i></b>	<b><i>Applications</i></b>
<b><i>Page 5</i></b>	<b><i>Retightening und Installation Instructions</i></b>
<b><i>Page 6</i></b>	<b><i>Disassembly and Assembly</i></b>
<b><i>Page 7</i></b>	<b><i>Storage Instructions</i></b>
<b><i>Page 8-14</i></b>	<b><i>Component Code Sheets</i></b>

---

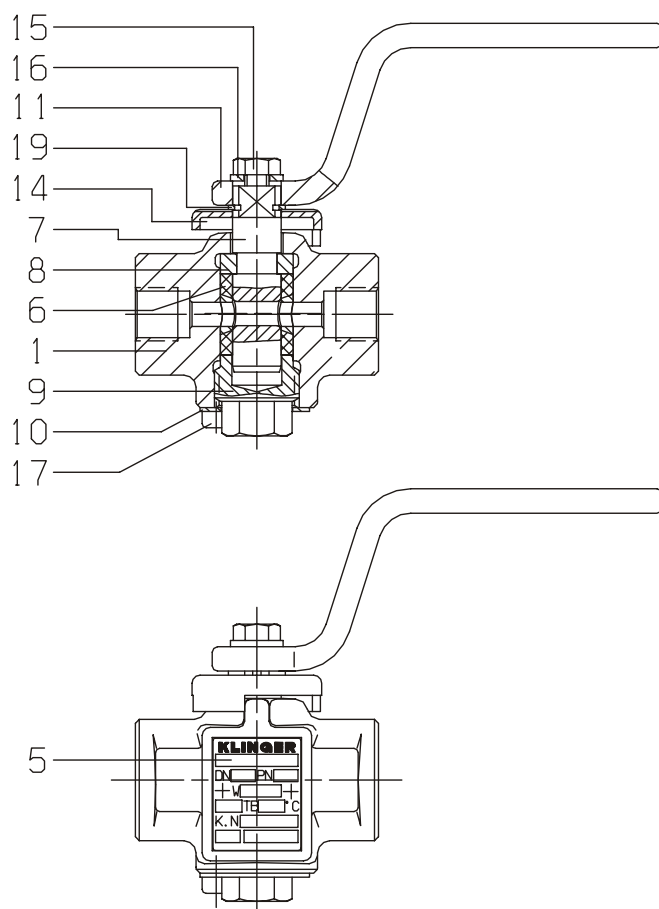

### Component names

- 1 Body
- 5 Name plate
- 6 Packing sleeve
- 7 Cock plug
- 8 Split ring
- 9 Tightening nut
- 10. Locking plate
- 11 Cock handle
- 14 Stop
- 15 Hexagon head screw
- 16 Washer
- 17 Cap screw
- 19 Circlip

*Klinger AB-series straight-way cocks are shut-off fittings which are developed for measurement technologies.*

### Operating principle

*A cylindrical cock plug and elastic packing sleeve enable rapid opening and closing over a 90° travel path. This is provided with a stop which is fixed rotation secured on the cock plug by using a circlip.*

*The unit is activated with a removable handle (also safeguard against unauthorized activation). All cocks are closed CLOCKWISE, except the ABIE model, which is closed counter clockwise.*

*The packing sleeve is secured to the body in locked position by a spring and a groove. An eyelet mounted across the ports keeps the entire cross section intact and protects the sealing material against erosion.*

*The larger sealing surface of the cock packing sleeve ensures tightness both across the ports and to the outside.*

*It is the only wearing part that can be replaced easily and quickly. The fitting itself needs not to be removed from the tubing.*

*The cylindrical cock plug is prevented from slipping out of the body by a split ring.*

*The position of the through hole is visible at the twin edge of the plug, or at the notches of the cock plug and stop, also at the cock handle.*

*In the event of leaks, the retightening nut can be used to retighten the packing sleeve in the open position, observing the necessary tightening torque. This threaded joint is safeguarded against loosening or manipulation by a locking plate.*

*AB cocks can be installed in any position and are not limited to any specific flow-direction.*

### **AB cocks for General Use**

*- as a shut-off fitting for all media encountered in practice per the media table in our catalogue and within the respectively indicated limits of application.*

### **AB Cocks as Instrument Lead Cocks**

- as pressure gauge cocks for connecting manometers and test manometers.*
- as indicator cocks for connecting indicators*
- as special instrument lead cocks for instrumentation and control engineering as a whole*

### **AB Cocks as Drain Cocks**

*A special application involving our liquid-level gauges.*

---

## Resealing

The life-time of a graphite sleeve is so high that there is normally no need for resealing. The effect of resealing when using graphite as material is smaller than using e.g. Kor-P. But resealing could also be useful to bridge over the time-period of sleeve changing.

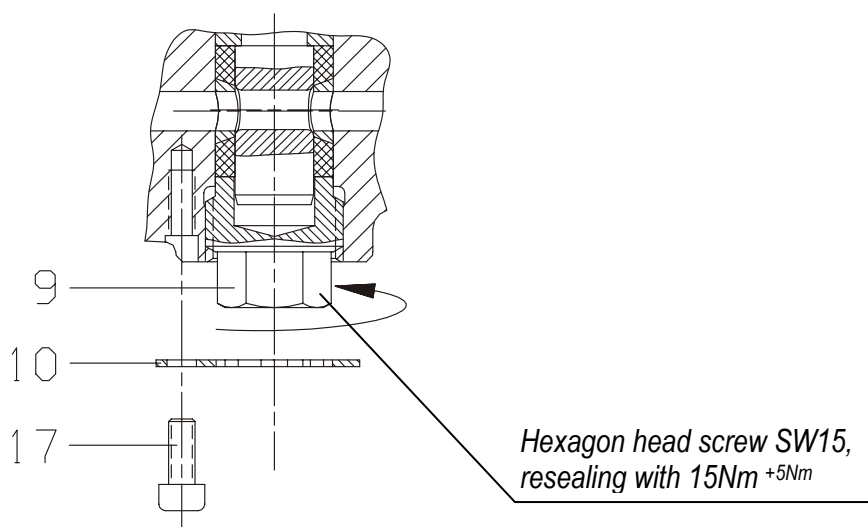

**ATTENTION:** Resealing is only possible in OPEN position!

- Loosen cap screw (item 17)
- Remove locking plate (item 10)
- use tightening nut (item 9) for resealing – tightening torque 15Nm<sup>+5Nm</sup>
- Put on locking plate in such a way as to allow the mounting of the cap screw

## Installation Instructions

If an AB cock has developed a leakage and retightening no longer seals the leak, the packing sleeve must be replaced. If the cock plug is found to be damaged after disassembly, it must also be replaced.

---

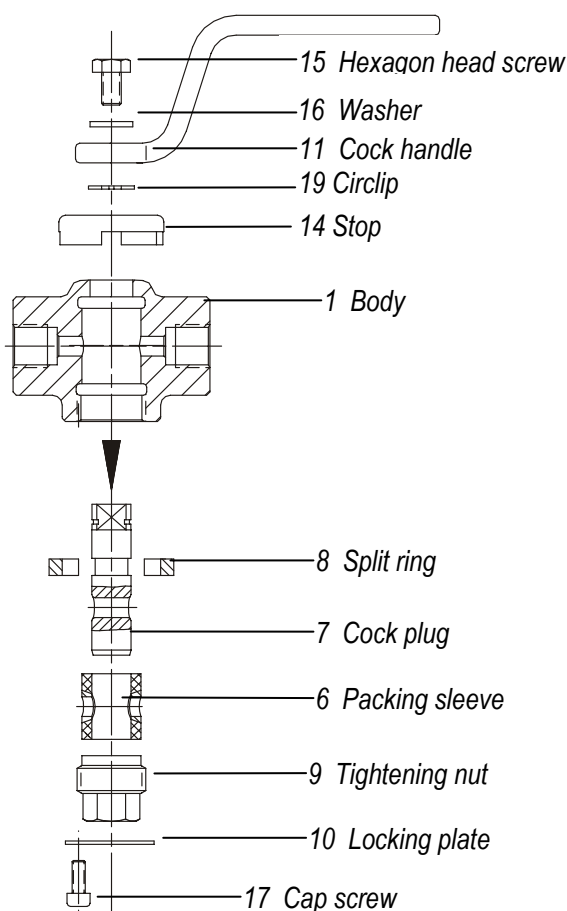

## Dismantling

- Loosen cap screw (item 17)
- Remove locking plate (item 10)
- Unscrew tightening nut (item 9)
- Loosen hexagon head screw (item 15), remove washer (item 16) and cock handle (item 11) from cock plug (item 7)
- Remove circlip (item 19) and stop (item 14) from cock plug (item 7)
- Knock cock plug (item 7) with split ring (item 8) and packing sleeve (item 6) out of the body (item 1)
- Take off split ring (item 8) and press cock plug (item 7) through the packing sleeve (item 6)

## Assembly

- Insert split ring (item 8) in the groove of the cock plug (item 7)
- Slide packing sleeve (item 6) onto the cock plug (item 7) up to the split ring (item 8)
- Press the entire unit into the hole of the body

**ATTENTION:** The packing sleeve spring must rest in the groove of the body hole.  
The packing sleeve eyelets may not protrude or lie titled in the packing sleeve through the hole.

- Screw in the tightening nut (item 9) – tightening torque:  $15\text{Nm}^{+5\text{Nm}}$
- Slide the stop (item 14) onto the cock plug (item 7) and secure it with the circlip (item 19)
- Place the cock handle (item 11) and the Washer (item 16) on the cock plug (item 7) and fix them with a hexagon head screw (item 15)
- Put on the locking plate (item 10), fasten it with hexagon a head screw (item 17)

## **Storage Instructions**

*The fittings must be stored in accordance with DIN 3230, sheet 1 in closed rooms, in a non-corrosive atmosphere, and protected against moisture and dirt. Replacement parts especially packing sleeves must be stored in dry, cool rooms.*

---

**Components for Type ABM 12, ABZ 12, ABMZ 12  
KLINGER Straight-Way Cocks**

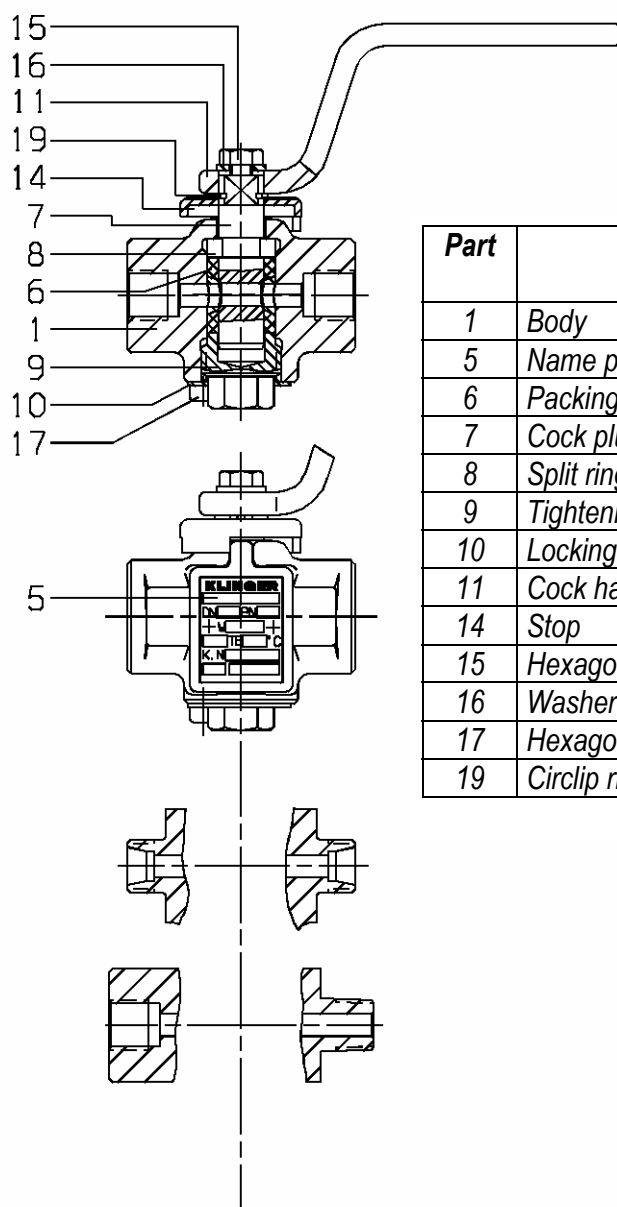

Part	Name	Material		Spare Parts
		VIII	X	
1	Body	1.0460	1.4571	
5	Name plate	1.4301	1.4301	
6	Packing sleeve	KAF	KAF	*
7	Cock plug	1.4401	1.4401	*
8	Split ring	1.4401	1.4401	
9	Tightening nut	1.4401	1.4401	
10	Locking plate	1.4401	1.4401	
11	Cock handle	0.8135	0.8135	
14	Stop	1.4401	1.4401	
15	Hexagon head screw	A4	A4	
16	Washer	A4	A4	
17	Hexagon head screw	A4	A4	
19	Circlip ring	1.4034	1.4034	

### Components for Type ABI 12/A MAIHAK KLINGER-Straight Way Cocks

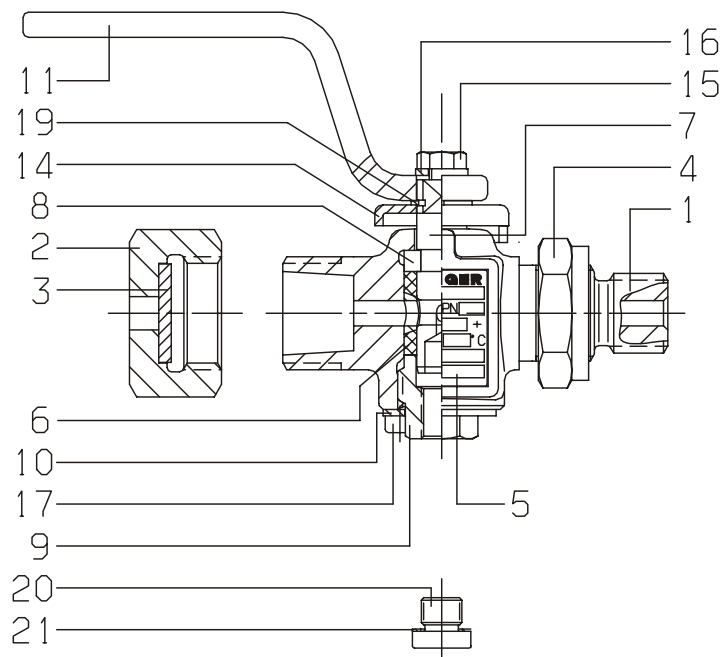

Part	Name	Materials	Spare parts
1	Body	1.0460	
2	Cap nut	1.0715.07	
3	Gasket	2.0090.26	
5	Name plate	1.4301	
6	Packing sleeve	KAF	*
7	Cock plug	1.4401	*
8	Split ring	1.4401	
9	Tightening nut	1.4401	
10	Locking plate	1.4401	
11	Cock handle	0.8135	
14	Stop	1.4401	
15	Hexagon head screw	A4	
16	Washer	A4	
17	Cap screw	A4	
19	Circlip ring	1.4034	
20	Screw plug	1.4571	
21	Gasket	K-Sil C4500	

### Components for Type ABI 12/D MAIHAK KLINGER Straight-Way Cocks

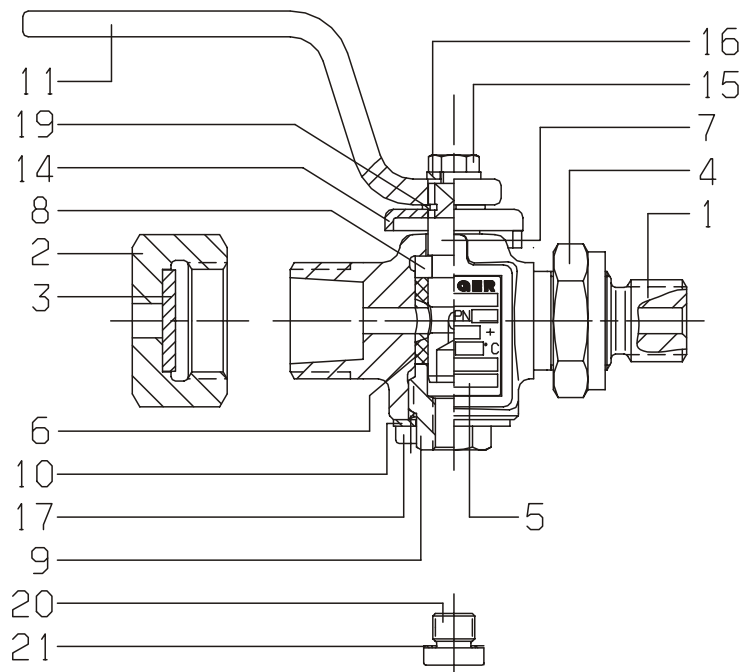

<b>Part</b>	<b>Name</b>	<b>Material</b>	<b>Spare Parts</b>
1	Body	1.0460	
2	Cap nut	1.0715.07	
3	Gasket	2.0090.26	
4	Counter nut	0.0715.07	
5	Name plate	1.4301	
6	Packing sleeve	KAF	*
7	Cock plug	1.4401	*
8	Split ring	1.4401	
9	Tightening nut	1.4401	
10	Locking plate	1.4401	
11	Cock handle	0.8135	
14	Stop	1.4401	
15	Hexagon head screw	A4	
16	Washer	A4	
17	Cap screw	A4	
19	Circlip ring	1.4034	
20	Screw plug	1.4571	
21	Gasket	K-Sil C4500	

### Components for Type ABIE 12/A MAIHAK KLINGER Straight-Way Cocks

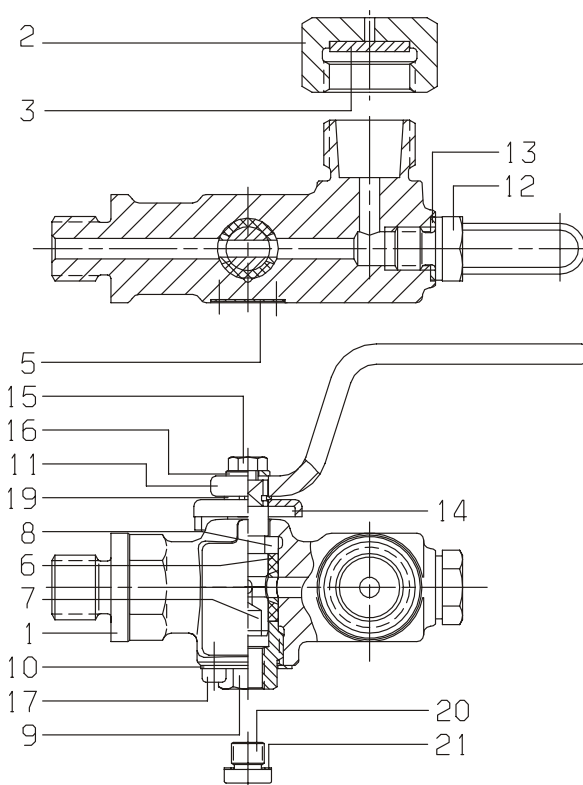

Part	Name	Material	Spare Parts
1	Body	1.0460	
2	Cap nut	1.0715.07	
3	Gasket	2.0090.26	
5	Name plate	1.4301	
6	Packing sleeve	KAF	*
7	Cock plug	1.4401	*
8	Split ring	1.4401	
9	Tightening nut	1.4401	
10	Locking plate	1.4401	
11	Cock handle	0.8135	
12	Plug	1.0715.07	
13	Gasket	2.0090.26	
14	Stop	1.4401	
15	Hexagon head screw	A4	
16	Washer	A4	
17	Cap screw	A4	
19	Circlip ring	1.4034	
20	Screw plug	1.4571	
21	Gasket	K-Sil C4500	

## Components for Type ABIE 12/D MAIHAK KLINGER Straight-Way Cocks

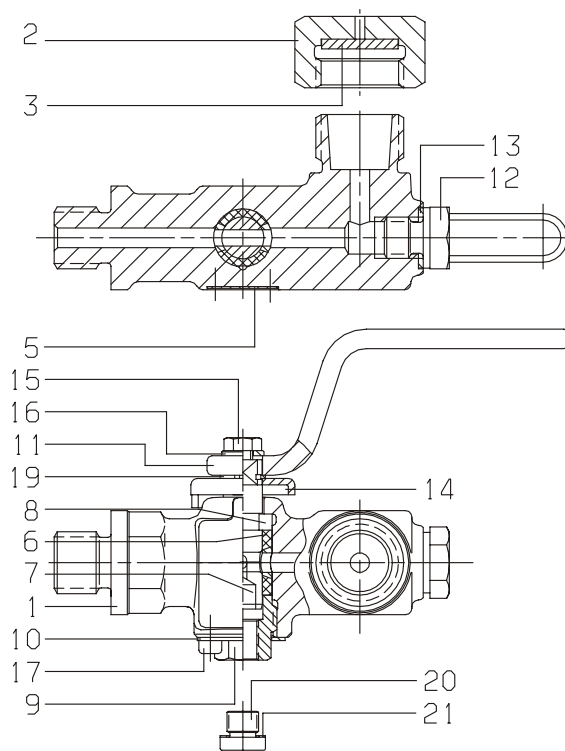

<b>Part</b>	<b>Name</b>	<b>Material</b>	<b>Spare Parts</b>
1	Body	1.0460	
2	Cap nut	1.0715.07	
3	Gasket	2.0090.26	
4	Counter nut	1.0715.07	
5	Name plate	1.4301	
6	Packing sleeve	KAF	*
7	Cock plug	1.4401	*
8	Split ring	1.4401	
9	Tightening nut	1.4401	
10	Locking plate	1.4401	
11	Cock handle	0.8135	
12	Plug	1.0715.07	
13	Gasket	2.0090.26	
14	Stop	1.4401	
15	Hexagon head screw	A4	
16	Washer	A4	
17	Cap screw	A4	
19	Circlip ring	1.4034	
20	Screw plug	1.4571	
21	Gasket	K-Sil C4500	

## Components for Type ABIE 12/D BURMEISTER KLINGER Straight-Way Cocks

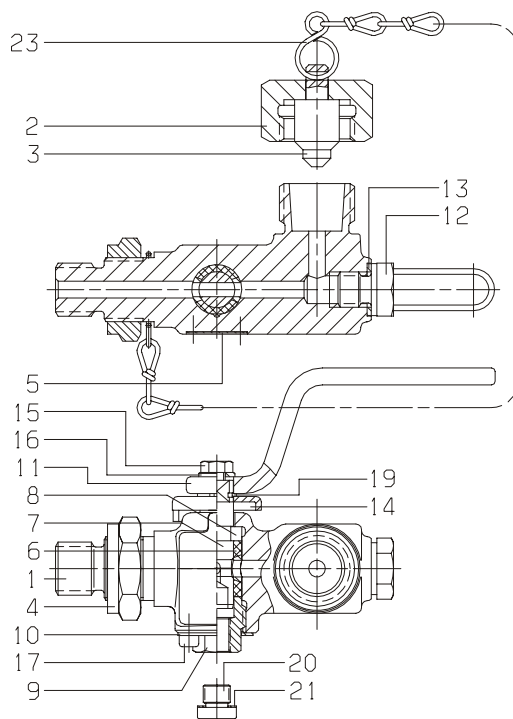

<b>Part</b>	<b>Name</b>	<b>Material</b>	<b>Spare Parts</b>
1	Body	1.0460	
2	Cap nut	1.0715.07	
3	Sealing Cone	2.0402.20	
4	Counter nut	1.0715.07	
5	Name plate	1.4301	
6	Packing sleeve	KAF	*
7	Cock plug	1.4401	*
8	Split ring	1.4401	
9	Tightening nut	1.4401	
10	Locking plate	1.4401	
11	Cock handle	0.8135	
12	Plug	1.0715.07	
13	Gasket	2.0090.26	
14	Stop	1.4401	
15	Hexagon head screw	A4	
16	Washer	A4	
17	Cap screw	A4	
19	Circlip ring	1.4034	
20	Screw plug	1.4571	
21	Gasket	K-Sil C4500	
23	Chain	St-Ni plat.	

### Components for Type MABI 12 KLINGER Straight-Way Cocks

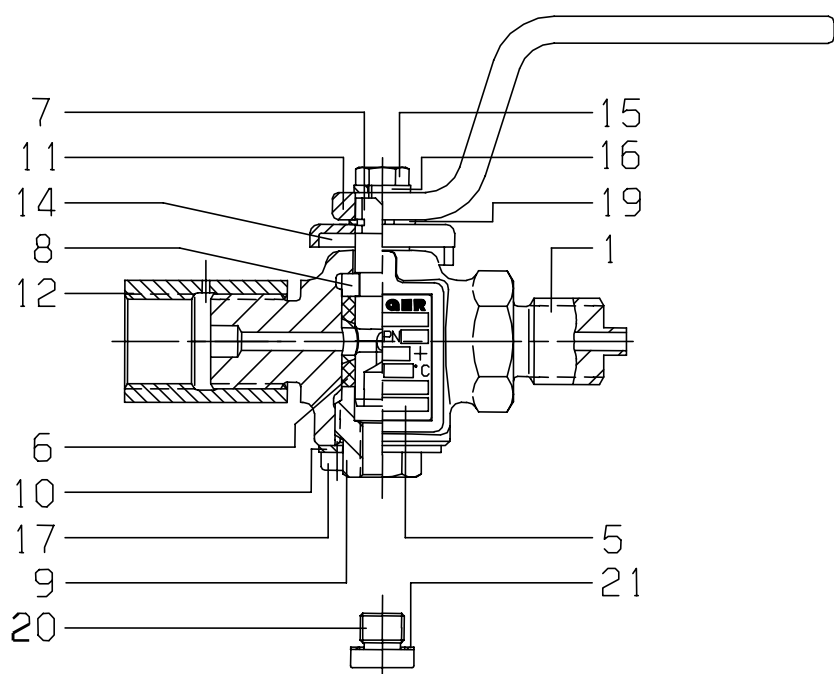

<b>Part</b>	<b>Name</b>	<b>Material</b>		<b>Spare Parts</b>
1	Body	1.0460	1.4571	
5	Name plate	1.4301	1.4301	
6	Packing sleeve	KAF	KAF	*
7	Cock plug	1.4401	1.4401	*
8	Split ring	1.4401	1.4401	
9	Tightening nut	1.4401	1.4401	
10	Locking plate	1.4401	1.4401	
11	Cock handle	0.8135	0.8135	
12	Right-left coupling	1.0711.07	1.4571	
14	Stop	1.4401	1.4401	
15	Hexagon head screw	A4	A4	
16	Washer	A4	A4	
17	Cap screw	A4	A4	
19	Circlip ring	1.4034	1.4034	
20	Screw plug	1.4571	1.4571	
21	Gasket	K-Sil C4430	K-Sil C4430	