

**Model: JY-800S**

**Rating: 800 CWP**



**Design feature:**

- Y-Type Low pressure drop streamlined design.
- Generously sized strainer screens.
- Compact end to end dimension.
- With Stainless Steel SS316 12 Mesh Screen, Other mesh upon request.
- With Drain Plug.
- Investment cast body construction.
- DIN 50049-3.1 Certificate Available

**Specifications:**

- Construction: Y type, Screw-in cap design.
- Flow bore: Full Port.
- Rating: 800WOG (PN40)
- Temperature: -20°F ~ 400°F (PTFE Seal)
- Materials: ASTM A351 CF8M/ CF8
- Size range: 1/4" ~ 3"
- End Connections: Threaded, Socket-Weld.

**Standard:**

- Basic Design to ANSI B16.34
- Female Thread: NPT, PT, BSPP, BSPT, DIN 259/2999.
- Inspection & testing according to API 598.
- PED 97/23/EC; ISO 9001

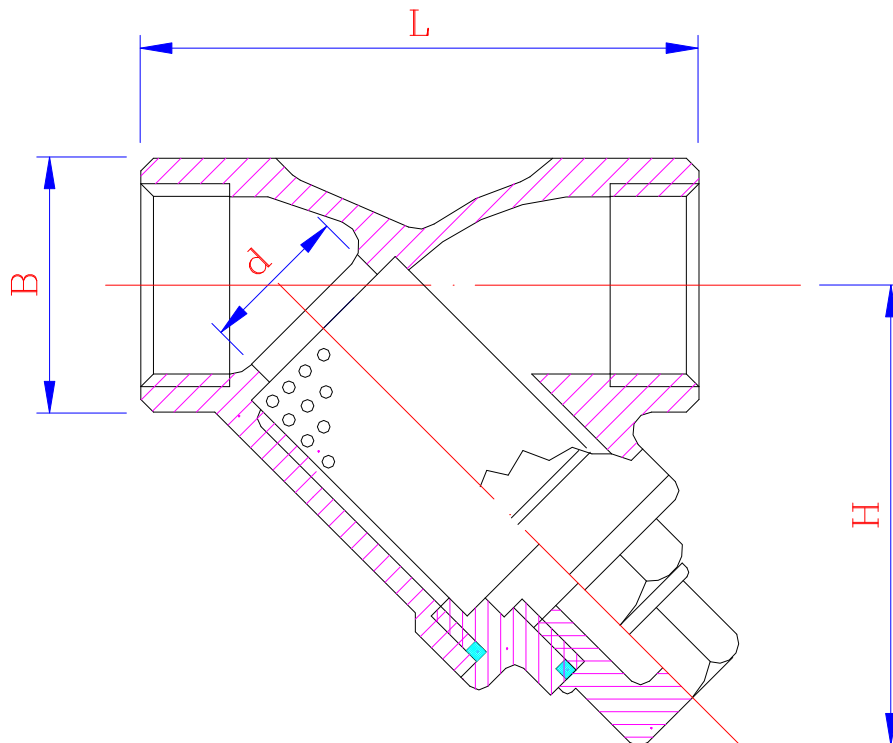

### Dimensions List:

Size	d	B	H	L	Weight (kg)
1/4"	11	23	46	65	0.24
3/8"	13	23	46	65	0.23
1/2"	15	26	46	65	0.23
3/4"	20	33	55	80	0.36
1"	25	41	70	90	0.70
1-1/4"	32	49	73	105	0.90
1-1/2"	38	56	81	120	1.20
2"	50	69	94	140	1.90
2-1/2"	65	87	120	170	---
3"	80	102	140	200	---

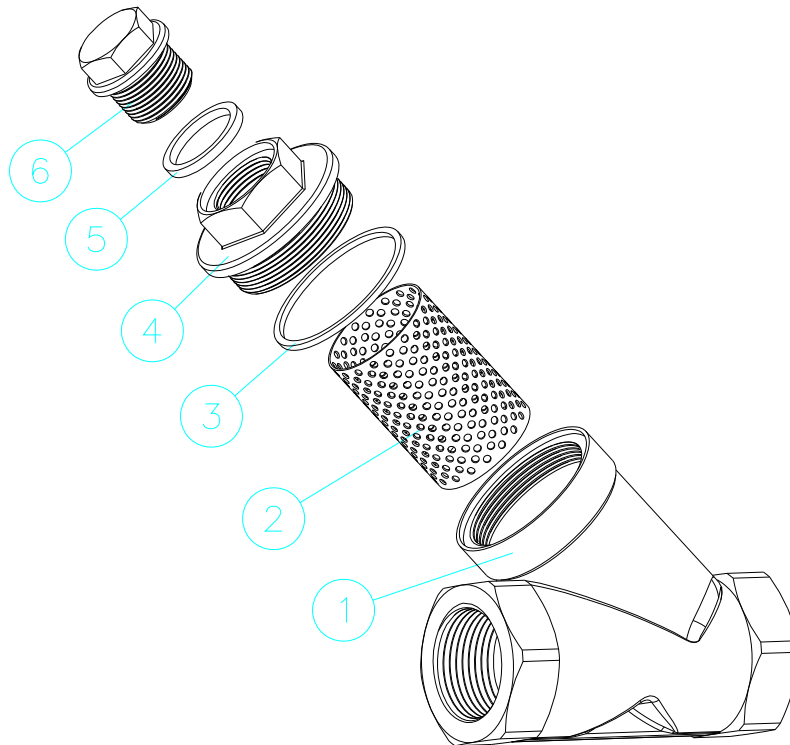

### MATERIALS LIST:

NO	PART NAME	MATERIAL	NO	PART NAME	MATERIAL
1	Body	ASTM A351 CF8M	7		
2	Screen	SS316 12 Mesh	8		
3	Gasket	PTFE	9		
4	Bonnet	ASTM A351 CF8M	10		
5	Gasket	PTFE	11		
6	Blow Off	ASTM A351 CF8M	12		